



# Heckmann Building Products Inc.

1501 N. 31<sup>st</sup> Avenue

Melrose Park, IL 60160-2911

800-621-4140 or 708-865-2403 Fax: 708-865-2640

[www.heckmannbuildingprods.com](http://www.heckmannbuildingprods.com)

## SUBMITTAL SHEET: #278 WELDED PLATE-STRAP STONE ANCHOR

### MADE TO ORDER

**Thickness:** 1/4", 3/16", 1/8", 11 gage, 12 gage,  
& 16 gage.

**Strap Width:** 1-1/4" minimum recommended.

**Length:** Specify length as the inside  
dimensions between the bend and plate.

**Bend with Hole:** 1" minimum recommended.

You should consider the overall length of the  
anchor and the height of the bend to make sure  
there is enough room for the installer to get the  
screw and tool in place without interference  
from the welded plate. Hole should be  
minimum of 1/16" larger than your screw size.  
(3/8" screw will use a 7/16" diameter hole).

**Plate:** Specify plate size (width and length).  
Unless noted, plate will be welded in center of  
height dimension.

Available in Stainless Steel, or Hotdip  
Galvanized After Fabrication. Stainless Steel  
recommended for any exterior stone  
application.

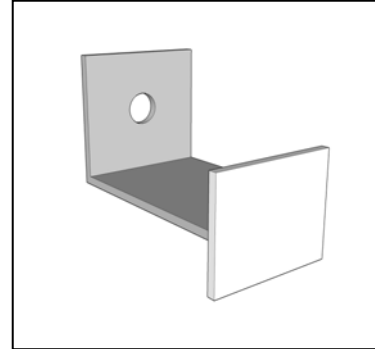

### Stainless Steel:

Sheet metal anchors and ties: ASTM A 167 AISI Type 304.

Plate and bent bar anchors: ASTM A 666 AISI Type 304.

Wire ties and anchors: ASTM A 580 AISI Type 304.

### Hotdip Galvanized:

ASTM A 153 Class B-2: (1.50 oz/ ft<sup>2</sup>).(0.46kg/m<sup>2</sup>)

Approvals:

Comments: