

**Submittal Sheet**  
**#213 Double Pintle Brick Veneer Anchor**  
**#282 Double Pintle Tie**

The 14 gage anchor is attached directly to the backup system. Insulation is then placed above and below the wire tie tab. (Note: If ties are placed 16" on center, your insulation will have to be in 16" strips). Pintle ties are placed in the tabs allowing for 1 1/4" vertical adjustment above or below the tab.

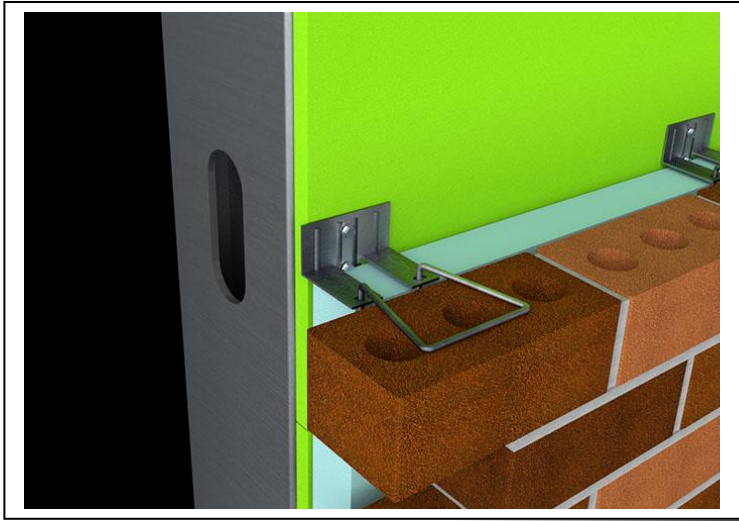

**Standards:**

**#213 Plate**

Thickness: 14 gage

Insulation Size:	0"	1"	1-1/2"	2"
	2-1/2"	3"	3-1/2"	4"

**#282 Pintle Tie**

Diameter: 3/16"

Length:  3 1/4"     4 1/4"     5 1/4"

Finish:  Stainless type 304     Hot Dip Galvanized

Quantity: \_\_\_\_\_

**Material Specifications**

**Stainless Steel:** Sheet metal anchors and ties: ASTM A 167, ASTM A 666, ASTM A 240/A240M AISI Type 304.  
Wire ties and anchors: ASTM A 580 AISI Type 304  
(AISI Type 316 available upon request)

**Hotdip Galvanized:** ASTM A 153 Class B-2: (1.50 oz/ ft<sup>2</sup>)(0.46kg/m<sup>2</sup>)

**Plain Carbon Steel:** ASTM A1008/A1008M Structural Steel ASTM A36/A36M-08  
Wire: ASTM A 82/A82M Tensile Strengths 80,000 psi Yield Point 70,000 psi