

Used for tying two masonry walls that require an adjustable anchoring system. #262 eye rod anchor is embedded in a CMU backup wall. The #263 pintle is placed in the veneer joint.

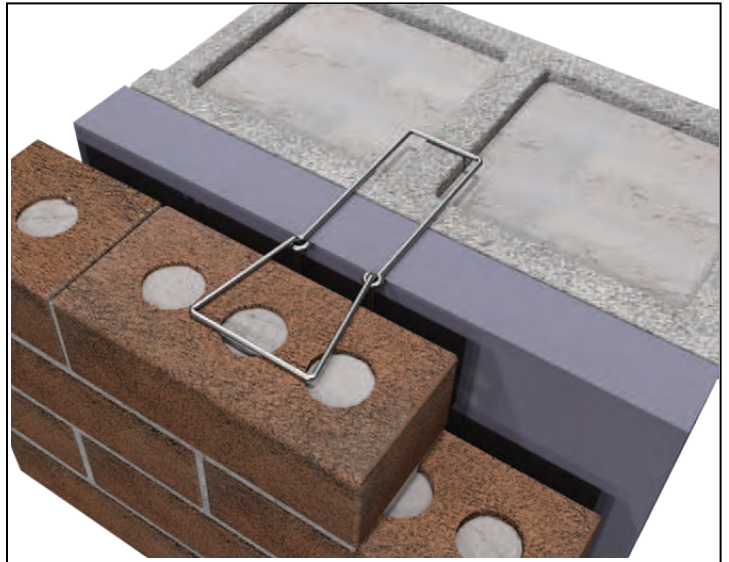
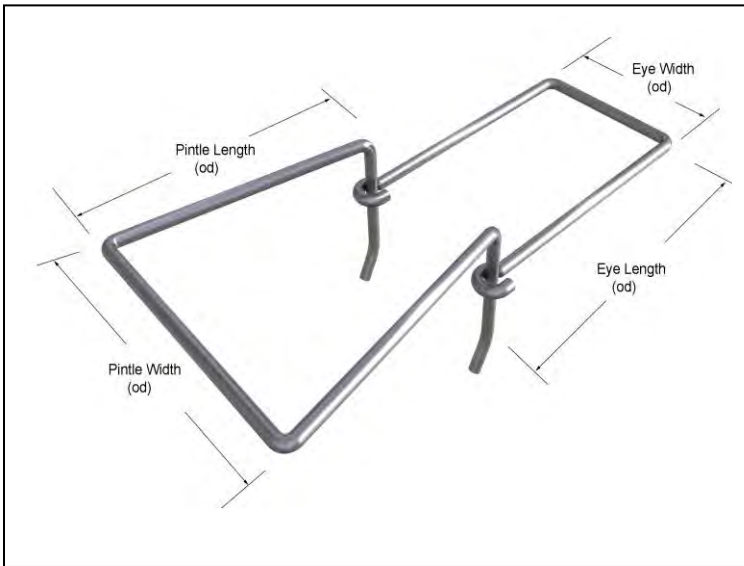

**Standards:**

**#262 Double Eye Rod Anchor**

Thickness: 3/16"  
 Length:  2 3/4"  4 3/4"  
 Width: 2"

**#263 Double Pintle Tie**

Thickness: 3/16"  
 Length:  3 1/4"  4 1/4"  5 1/4"  
 Width: 2-1/4"

Finish:  Hot Dip Galvanized  Stainless Steel

Quantity (pairs): \_\_\_\_\_

**Material Specifications**

**Stainless Steel:** Wire ties and anchors:  
 ASTM A 580 AISI Type 304

**Hotdip Galvanized:** ASTM A 153 Class B-2:  
 (1.50 oz/ ft<sup>2</sup>)(0.46kg/m<sup>2</sup>)

**Plain Carbon Steel:** ASTM A1008/  
 A1008M Structural Steel ASTM A36/  
 A36M-08

Wire: ASTM A 82/A82M Tensile Strengths  
 80,000 psi Yield Point 70,000 psi