

Submittal Sheet
#341-A L-Anchor with Two Holes

Custom Made:

Used for attaching masonry to various backups.
 Specify length, width, bend length, steel type and hole configurations.

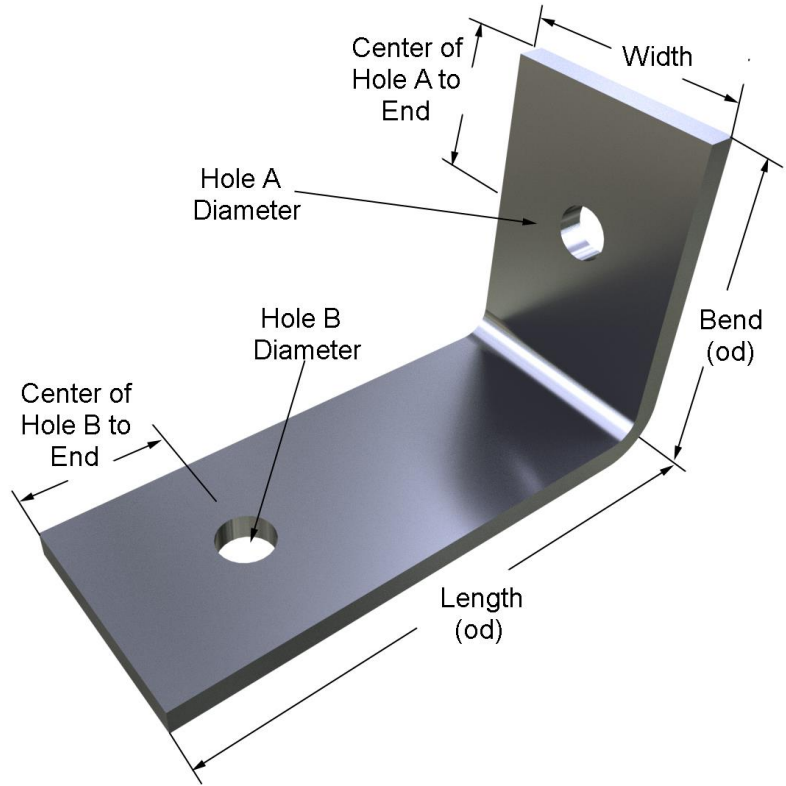

Made to Order:

Thickness: 3/8" 1/4" 3/16" 1/8"
 12 gage 14 gage 16 gage

Length od: _____ Width: _____

Bend (od): _____

Hole A Diameter: _____ Hole B Diameter: _____

Center of Hole A to End: _____

Center of Hole B to End: _____

Finish: Stainless type 304 Hot Dip Galvanized
 Mill Galvanized Zinc Alloy 710

Quantity: _____

Material Specifications

Stainless Steel: Sheet metal anchors and ties: ASTM A 167, ASTM A 666, ASTM A 240/A240M
 AISI Type 304.

Wire ties and anchors: ASTM A 580 AISI Type 304 (AISI Type 316 available upon request)

Hotdip Galvanized: ASTM A 153 Class B-2: (1.50 oz/ ft²).(0.46kg/m²)

Mill Galvanized: Sheet metal anchors and ties: ASTM A 653 G60

Wire: ASTM A 641 (0.1 oz/ ft².)

Plain Carbon Steel: ASTM A1008/A1008M

Structural Steel ASTM A36/A36M-08

Wire: ASTM A 82/A82M Tensile Strengths 80,000 psi Yield Point 70,000 psi

Firewall Anchors: Rolled Strip Zinc Alloy 710. (Firewall alloy 1/8" and 16 gage only)